

WARNING

DO NOT CONNECT DIRECTLY TO LINE VOLTAGE POWER!

Read all warnings and Installation instructions thoroughly.

Safety & Warnings

1. Install in accordance with national and local electrical code regulations.
2. This product is intended to be installed and serviced by a qualified, licensed electrician.
3. Ensure applicable wire is installed between driver, fixture, and any controls in-between. When choosing wire, factor in voltage drop, amperage rating, and type (in-wall rated, wet location rated, etc.). Inadequate wire installation could overheat wires, and cause fire.
4. Do not install in environment where LED chips are exposed to direct sunlight as damage to the phosphor will occur.
5. Do not install in environment where excessive heat may exist (ex. close proximity to fireplace, etc.) See Ambient Temperature ratings
6. Do not install indoor LED tape light products in outdoor / wet location environments. Only wet location tape light models are rated for outdoor / wet locations.
7. Do not modify product beyond instructions or warranty will be void.
8. Tape light must be handled with care. Excessive handling, bending, and pressure may damage the product, voiding the warranty.
9. Actual color may vary from what is pictured on this sheet and other print materials due to the limitations of photographic processes.
10. We reserve the right to modify and improve the design of our fixtures without prior notice. We cannot guarantee to match existing installed fixtures for subsequent orders or replacements in regards to product appearance, CCT, or lumen output.

Tools For Install

Pencil

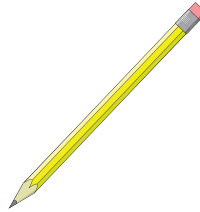

Ruler

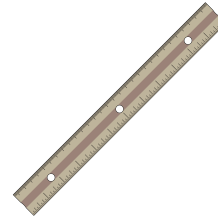

Painters Tape

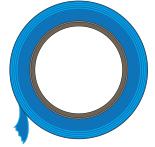

Phillips-head screwdriver and Countersunk screws

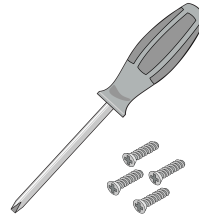

Jab Saw

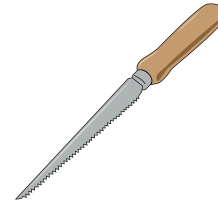

Metal File



Power Drill



Chop Saw

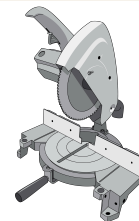

Wood Router

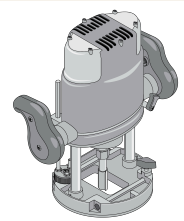

1. Determine Tape Light & Channel Length

1.1 - Determine Total Tape Light Length

Cut to desired length using scissors or diagonal cutters (cut at scissors icon) If applicable, attach appropriate connectors, which will slightly extend total length.

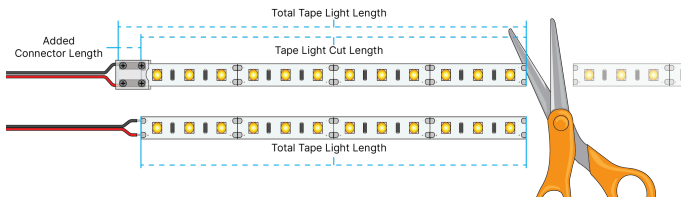

1.2 - Determine Channel / Cover Cut Length

Add 1 inch to the Total Tape Light Length to determine the Channel / Cover Cut Length. This will provide space to fit end cap harness.

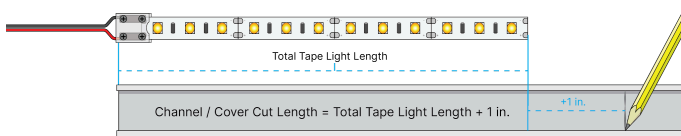

1.3 - Determine Total Fixture Length

Add the total length of both end caps to the Channel / Cover Cut Length to determine the total length of the Fixture.

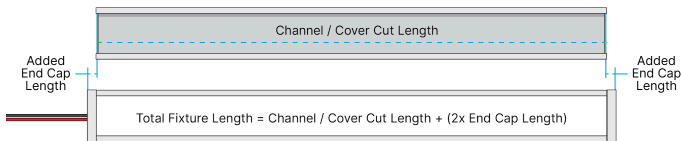

2. Cut Channel and Cover

To ensure channel and cover are cut to same length, and reduce damage to cover, wrap channel and cover in painters tape, marking cut point.

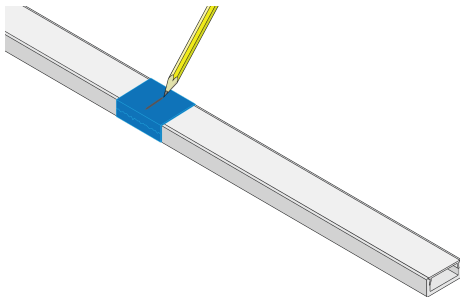

Cut to size with chop saw, bandsaw, reciprocating saw, rotary saw, or handsaw fitted with appropriate blade to cut metal.

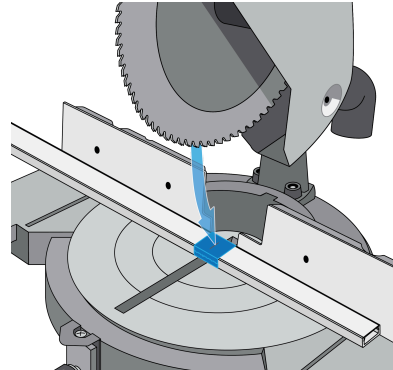

Remove tape from channel and finish edges using metal file.

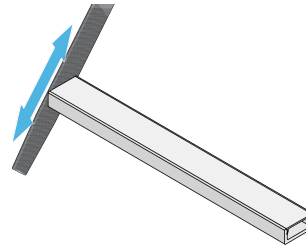

3. Clean and Adhere Tape Light

3.1 - Run an alcohol wipe along the inside of the channel to remove any dust or debris. Wipe with dry towel then let dry.

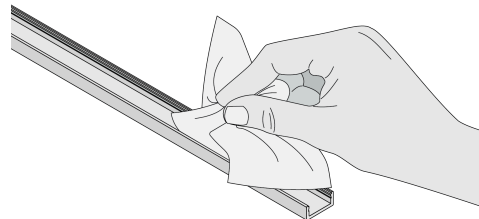

3.2 - Peel off adhesive backing from Tape Light

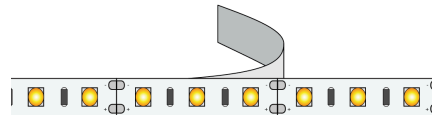

3.3 - Press Tape Light gently but firmly against channel, taking care not to press directly on LEDs.

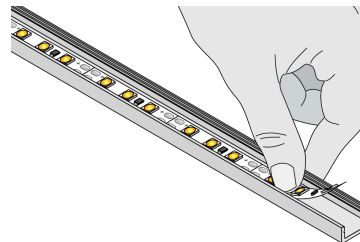

4. Assemble Fixture

4.1 - Bridge Channels

To bridge between two channels, lay channels end-to-end, then place cover over gap to keep ends flush.

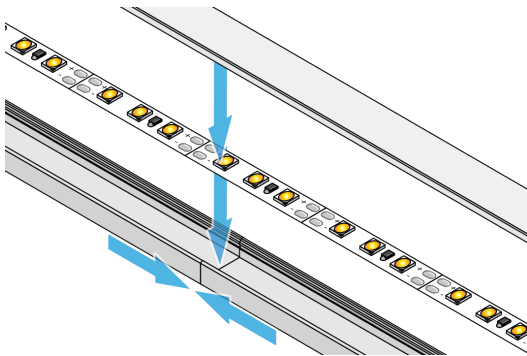

4.2 - Insert Cover

Fasten cover by firmly pressing one edge into channel, then the other.

Continue pressing in lens along channel until fully seated.

Flat Channel Cover

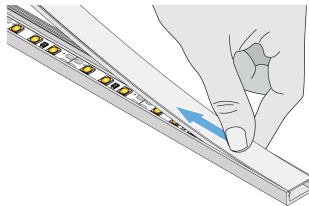
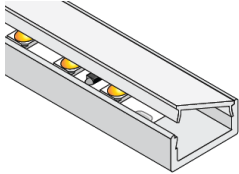

Angled Channel Cover

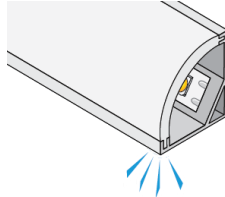
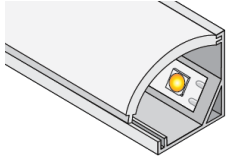

4.3 - Connect End Caps

Attach end caps and adhere with adhesive or glue if desired.

Open End Cap

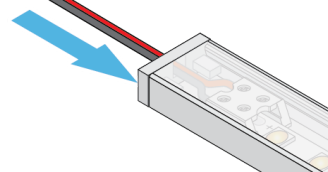

Closed End Cap

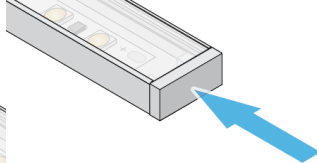

5a. Mounting (Mounting Clips)

5a.1 - Draw Guide Line

Draw guide line with ruler and pencil.

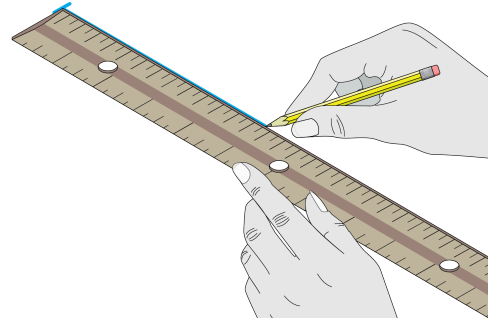

5a.2 - Fasten Mounting Clips

Mark holes. Use one clip for every two feet of channel. Fasten with countersunk screws with screwdriver or drill.

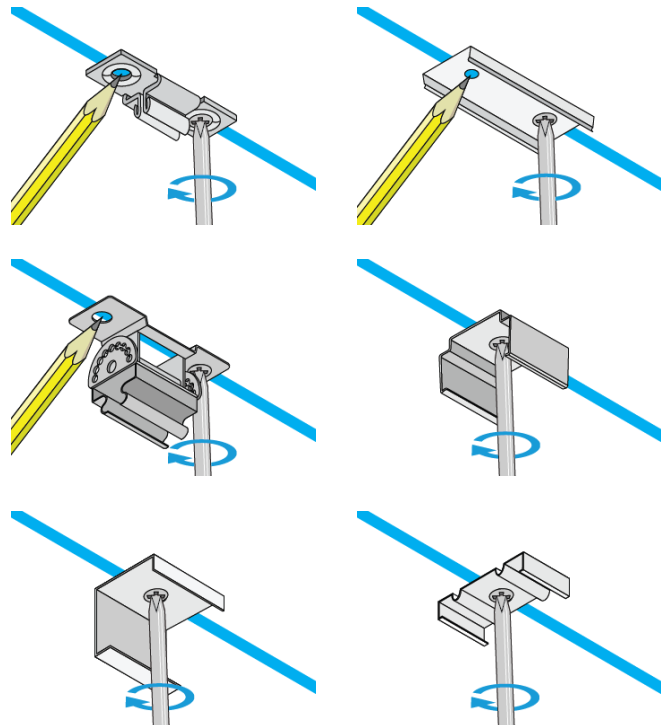

5b. Mounting (Direct Mounting)

5b.1 - Drill Mounting Holes Through Channel

Using power drill fitted with an appropriate bit to drill through metal, drill mounting holes through center of channel every two feet.

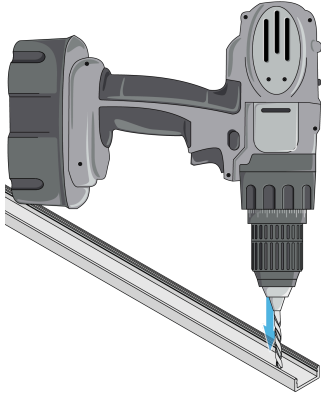

5b.2 - Fasten Channel to Surface

Fasten with countersunk screws with screwdriver.

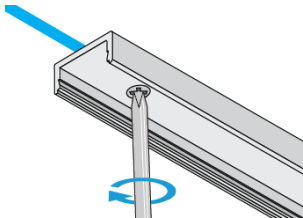

5c. Mounting (Millwork / Recessed)

5c.1 - Route Track to Recess Channel

Route track to a depth equal to channel height using router and appropriate diameter router bit. (Reference Channel Dimensions on page 5)

Clamp a guiding edge to surface to route an even track.

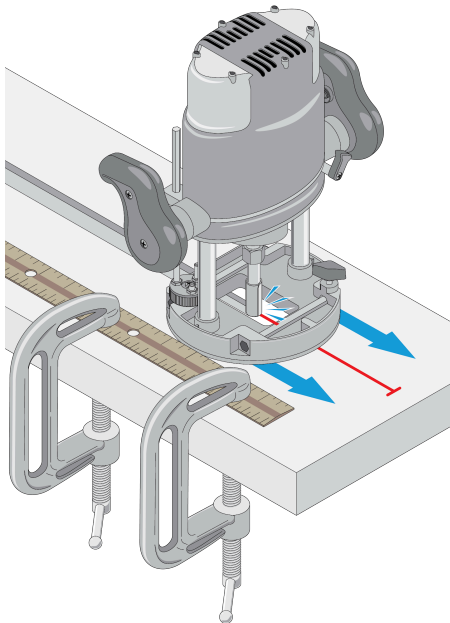

5c.2 - Prepare Track

Prep surface by removing dust and dirt. Apply an adhesive glue to the routed surface.

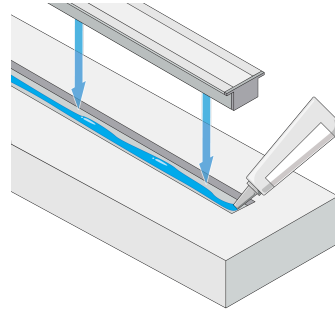

5c.3 - Place Channel in Track

Press channel into track, apply pressure, and allow adhesive to dry. (per directions printed on adhesive)

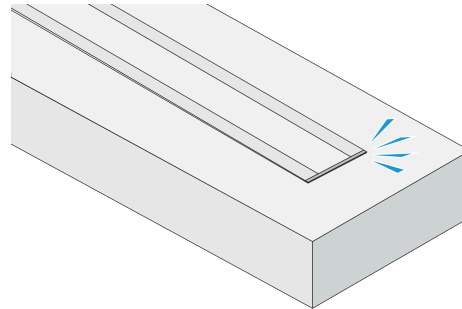

Channel Dimensions

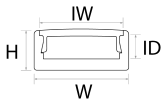
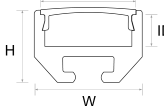
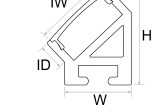
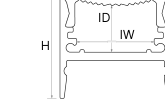
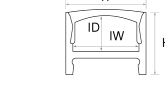
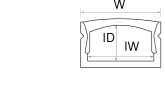
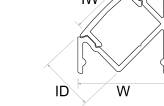
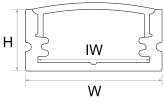
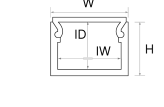
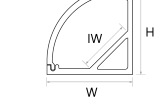
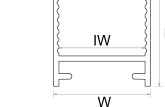
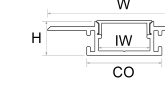
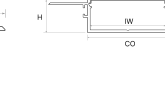
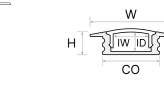
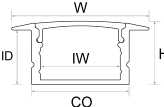
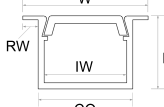
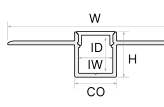
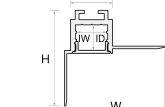
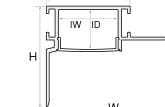
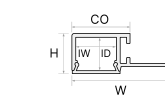
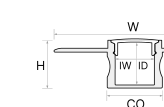
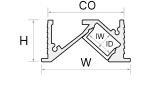
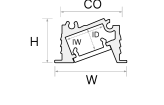
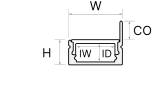
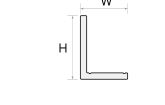
FSL	FSQ	F45	AR1	AR2	AR3	AR45
<p>Height (H): 0.38 in. Width (W): 0.82 in. Interior Depth (ID): 0.3 in. Interior Width (IW): 0.67 in.</p> 	<p>Height (H): 0.55 in. Width (W): 0.82 in. Interior Depth (ID): 0.27 in. Interior Width (IW): 0.67 in.</p> 	<p>Height (H): 0.94 in. Width (W): 0.67 in. Interior Depth (ID): 0.32 in. Interior Width (IW): 0.67 in.</p> 	<p>Height (H): 0.81 in. Width (W): 0.87 in. Interior Depth (ID): 0.45 in. Interior Width (IW): 0.79 in.</p> 	<p>Height (H): 0.55 in. Width (W): 0.63 in. Interior Depth (ID): 0.33 in. Interior Width (IW): 0.48 in. Interior Width W/Lens (IWL): 0.4 in.</p> 	<p>Height (H): 0.39 in. Width (W): 0.63 in. Interior Depth (ID): 0.33 in. Interior Width (IW): 0.48 in. Interior Width W/Lens (IWL): 0.4 in.</p> 	<p>Height (H): 0.73 in. Width (W): 0.73 in. Interior Depth (ID): 0.33 in. Interior Width (IW): 0.49 in. Interior Width W/Lens (IWL): 0.41 in.</p> 
FS1	FS2	FS45	F16	S1MUD	S2MUD	SSREC
<p>Height (H): 0.31 in. Width (W): 0.67 in. Interior Depth (ID): 0.25 in. Interior Width (IW): 0.58 in.</p> 	<p>Height (H): 0.57 in. Width (W): 0.74 in. Interior Depth (ID): 0.34 in. Interior Width (IW): 0.65 in.</p> 	<p>Height (H): 0.78 in. Width (W): 0.78 in. Interior Depth (ID): 0.54 in. Interior Width (IW): 0.6 in.</p> 	<p>Height (H): 0.89 in. Width (W): 0.77 in. Interior Depth (ID): 0.58 in. Interior Width (IW): 0.63 in.</p> 	<p>Height (H): 0.54 in. Width (W): 2.42 in. Interior Depth (ID): 0.44 in. Interior Width (IW): 0.81 in.</p> 	<p>Height (H): 0.8 in. Width (W): 3.86 in. Interior Depth (ID): 0.69 in. Interior Width (IW): 1.84 in.</p> 	<p>Height (H): 0.31 in. Width (W): 0.98 in. Interior Depth (ID): 0.21 in. Interior Width (IW): 0.46 in.</p> 
SREC	SSLREC	S0.5MUD	S0.5MUD-REV	S1MUD-REV	S1MUD-SF	S0.5MUD-FLX
<p>Height (H): 0.49 in. Width (W): 1.03 in. Interior Depth (ID): 0.42 in. Interior Width (IW): 0.59 in. Cut Out Width (CO): 0.74 in.</p> 	<p>Height (H): 0.38 in. Width (W): 0.65 in. Interior Depth (ID): 0.28 in. Interior Width (IW): 0.4 in. Cut Out Width (CO): 0.49 in. Recessed Wing (RW): 0.08 in.</p> 	<p>Height (H): 0.55 in. Width (W): 2.14 in. Interior Depth (ID): 0.44 in. Interior Width (IW): 0.39 in. Cut Out Width (CO): 0.51 in.</p> 	<p>Height (H): 1.5 in. Width (W): 1.43 in. Interior Depth (ID): 0.42 in. Interior Width (IW): 0.44 in. Cut Out Width (CO): 0.65 in.</p> 	<p>Height (H): 1.37 in. Width (W): 1.93 in. Interior Depth (ID): 0.51 in. Interior Width (IW): 0.79 in. Cut Out Width (CO): 1.16 in.</p> 	<p>Height (H): 0.57 in. Width (W): 1.47 in. Interior Depth (ID): 0.46 in. Interior Width (IW): 0.57 in. Cut Out Width (CO): 0.84 in.</p> 	<p>Height (H): 0.58 in. Width (W): 1.97 in. Interior Depth (ID): 0.35 in. Interior Width (IW): 0.47 in. Cut Out Width (CO): 0.68 in.</p> 
S45REC	S20REC	SS1CO	SLC	SRDCL		
<p>Height (H): 0.57 in. Width (W): 1.26 in. Interior Depth (ID): 0.19 in. Interior Width (IW): 0.42 in. Cut Out Width (CO): 1.11 in.</p> 	<p>Height (H): 0.46 in. Width (W): 0.78 in. Interior Depth (ID): 0.23 in. Interior Width (IW): 0.4 in. Cut Out Width (CO): 0.67 in.</p> 	<p>Height (H): 0.24 in. Width (W): 0.63 in. Interior Depth (ID): 0.23 in. Interior Width (IW): 0.48 in. Cut Out (CO): 0.3 in.</p> 	<p>Height (H): 0.78 in. Width (W): 0.59 in. Interior Depth (ID): 0.7 in. Interior Width (IW): 0.51 in.</p> 	<p>Height (H): 0.93 in. Width (W): 0.95 in. Interior Depth (ID): 0.5 in. Interior Width (IW): 0.48 in. Height W/o Cover (H): 0.72 in.</p> 